

P901

SERIES P901 AIR-DRIVEN HYDRAULIC POWER UNITS

Hydraulic performance from the seven models in this versatile range of power units include:

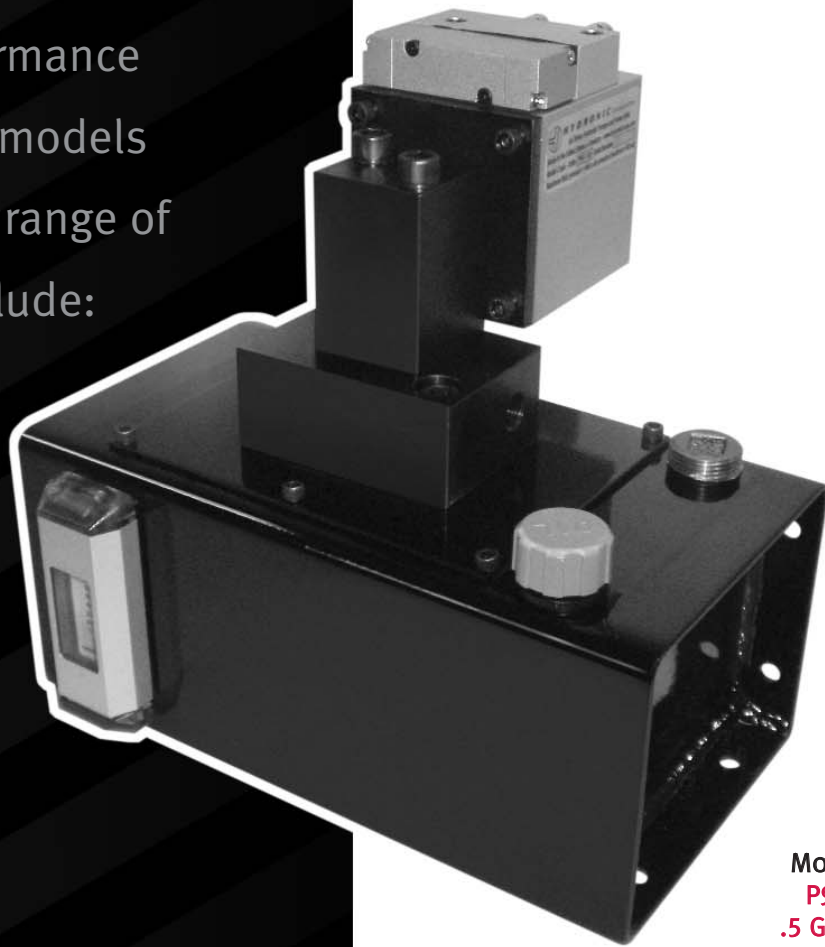

MODEL SHOWN
P901P-40 ON
.5 GALLON TANK

Models up to 1 gpm | Models up to 10,000 psi | Variable output

Pressure sustaining | Synthetic oils

Marked for worldwide use wherever
pressure sustaining is needed



The Hydronic P901 Series pump is designed to be used in conjunction with manifolds utilizing cartridge valves or DO3 type valves in order to reduce costs, envelope sizes and threaded connections. They are built for a long, steady and reliable service in a wide range of industrial applications.

The modular concept encompasses the latest in seal technology as well as established and durable metal ball type check valves. The air drive section is double acting, a feature which eliminates the need for large springs to return the piston assembly. This mechanism avoids the waste of energy associated with a spring return type and allows more of the air energy to be turned into hydraulic performance.

Clamping and workholding applications, as well as other areas where hydraulic pressure has to be held for periods of time, benefit from the seven ratios available. Flows up to 1 gpm and pressures up to 10,000 psi can be achieved easily and quietly. Where higher outputs are required, two different models can be arranged on the same manifold to provide high flows and high pressures. This hydraulic performance would be needed where a large bore cylinder is required to extend under low load and only the last part of the stroke requires the clamping force.

For maximum ease of installation, the P901 Series pump can be mounted vertically or horizontally and the air drive body can be rotated through three 90° positions around the hydraulic section. The maximum speed of the unit is controlled by careful gallery sizing to approximately 400 cycles per minute. This maintains the life of the seals to their full term, as well as avoiding the collision damage normally associated with single acting devices.

**P901 Series,
Model P901P-10
on .50 gallon tank**

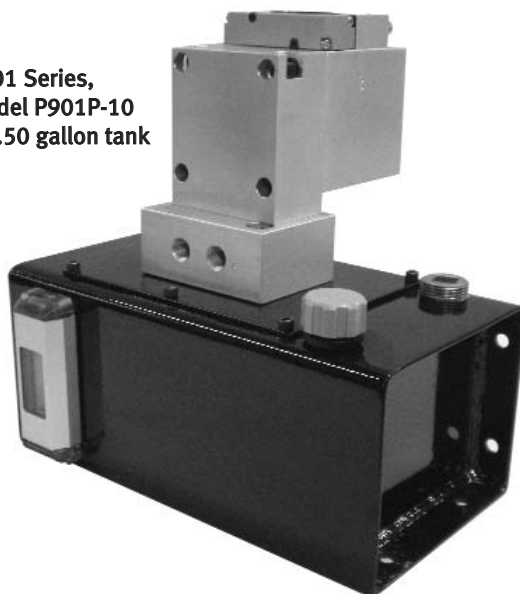

**P901 Series,
Model P901P-100-N-O-L
pump with manifold**



Hydronic P901 Series Pumps

- High performance, double acting pneumatic motor
- Miniature sizes with good flow rates per minute
- Self-limiting design for maximum cyclic speeds
- Pressure sustaining feature for clamping and workholding
- Manifold interface eliminates screwed connections
- Ideal for cartridge valves and stacking modules
- Reservoirs and custom manifolds available
- Complete power units with valves, reservoirs, air regulators and gauges are available

**VISIT US ONLINE AT HYDRONICCORP.COM
TO SEE OUR WHOLE LINE OF AVAILABLE PRODUCTS**

Flow and Pressure Performance Guides

P901-6 FLUID FLOW AGAINST PRESSURE

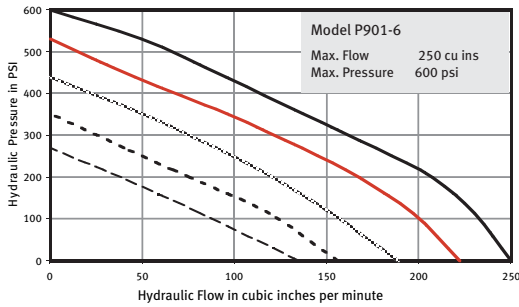

AIR PRESSURES AT:

- 100 PSI ———
- 90 PSI ———
- 75 PSI ———
- 60 PSI ·····
- 45 PSI - - - -

P901-10 FLUID FLOW AGAINST PRESSURE

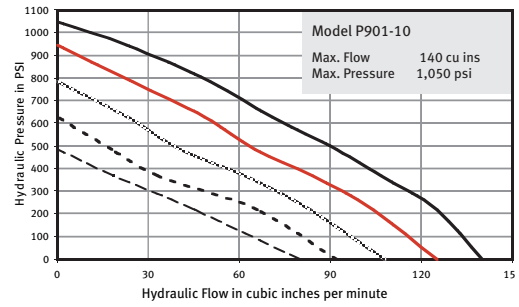

P901-20 FLUID FLOW AGAINST PRESSURE

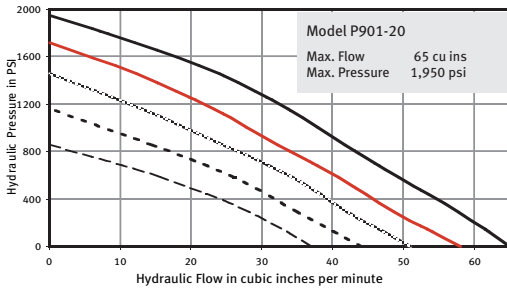

P901-40 Fluid Flow Against Pressure

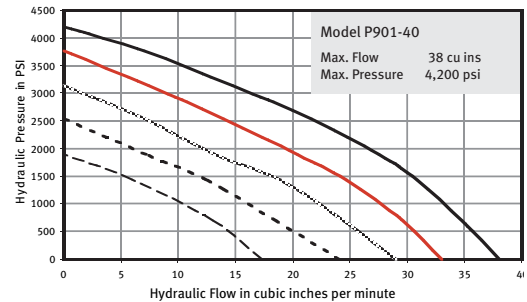

P901-60 FLUID FLOW AGAINST PRESSURE

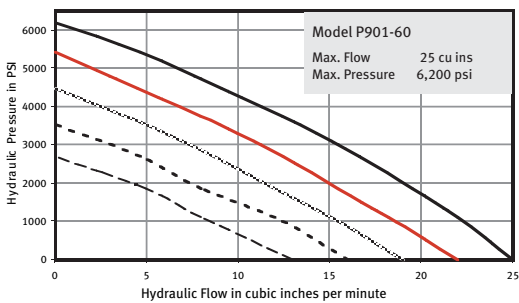

P901-80 FLUID FLOW AGAINST PRESSURE

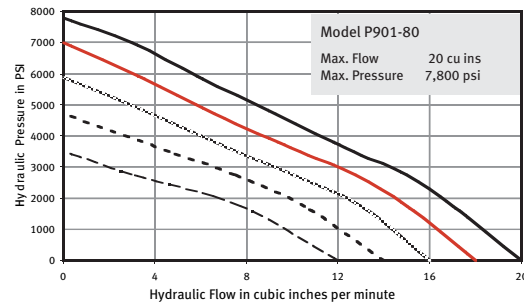

P901-100 FLUID FLOW AGAINST PRESSURE

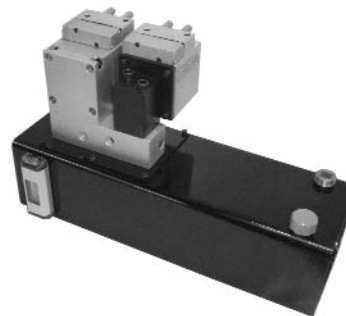
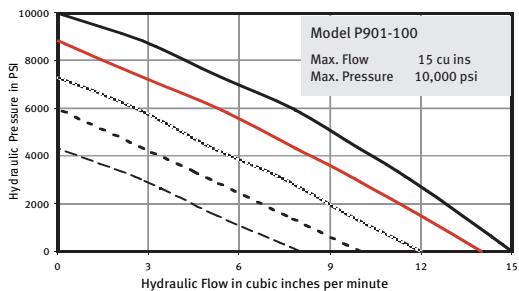

P901 Series, Model P901P-6/40-N-T15-HL Hi/Low Pump Combo on 1.5 gallon tank

P901 Pump Model	P901-6	P901-10	P901-20	P901-40	P901-60	P901-80	P901-100
Air Pressure psi (bar)	20-100 (1.5 – 7)						
Nominal Pressure Ratio	1 : 6	1 : 10	1 : 20	1 : 40	1 : 60	1:80	1:100
Max. Oil Pressure psi (bar)	600 (41)	1,050 (69)	1,950 (137)	4,200 (290)	6,200 (425)	7,800 (540)	10,000 (690)
Noise Level	78-80 dB @ 1meter						
Weight – Pump Only lbs. (Kg)	-6, -10, & -20 = 6.5 (3)			-40, -60, -80, & -100 = 5.25 (2.5)			

Note: Always fit an air filter/regulator with 40 micron rating and 5 scfm capacity.

Manifold Footprint:

High Pressure

A = 3/8-16 tapped holes
B = 0.25" suction port
C = 0.25" outlet port

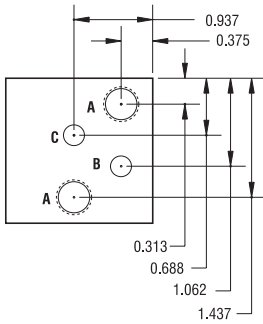

Low Pressure

A = 5/16-18 tapped holes
B = 0.25" suction port
C = 0.25" outlet port

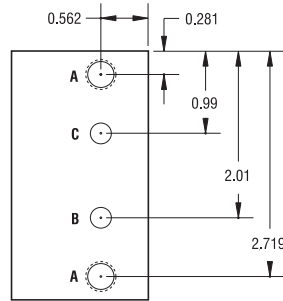

Gal	Designation	Dim	Weight # (kg)
0.5	T050	10.5	8 (3.7)
1.0	T10	13.5	10 (4.5)
1.5	T15	17.5	13 (5.9)

Reservoir Dimensions:

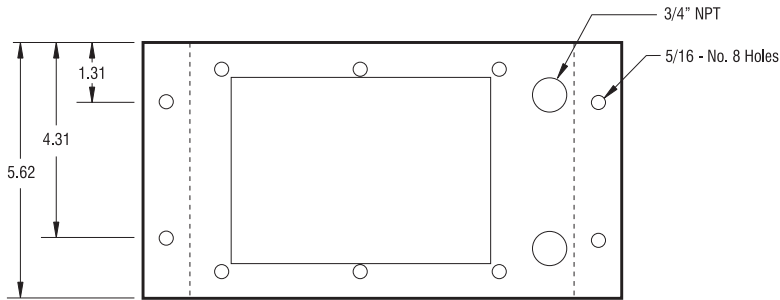

Top View

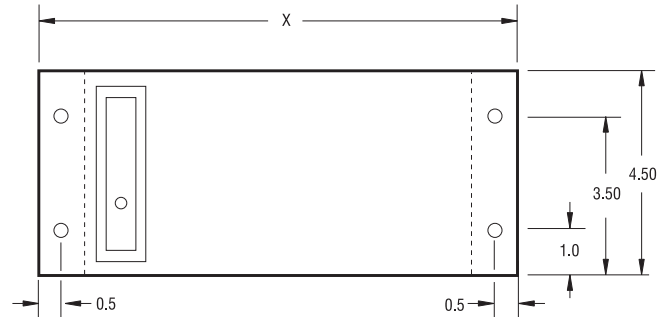

Front View

Hydronic P901 Series Ordering Code

Select specifications from the table and build an ordering code number, as shown in the sample.

PUMP STYLE	MODEL	RATIO*	SEAL	MOUNTING	CONNECTION*
	P901P	6	N	T050	P
Pump only (P)	P901P	1:6	N = BUNA	0 = Basic Pump Only	0 = Basic Pump Only
Automatic Release Valve - Normally Closed (A) (PA Fluid Connection Only)	P901A	1:10	V = VITON	T050 = 0.5 gal. Tank	L = Line Mounting
		1:20		T10 = 1 gal. Tank	DH = D03 Manifold
Automatic Release Valve - Normally Open (O) (ratios 6-20:1 Only - PO Fluid Connection Only)	P901O	1:40		T15 = 1.5 gal. Tank	P = Standard Manifold
		1:60			HL = Hi/Low Manifold (1/4" NPT)
		1:80			PA = Standard Manifold w/ N/C Automatic Release Valve (A Release Option Only)
		1:100			PO = Standard Manifold w/ N/O Automatic Release Valve (O Release Option Only)
		* Can combine ratios for a Hi/Low configuration			* Low pressure (ratios 6-20:1) #6 SAE
					* High pressure (ratios 40-100:1) 1/4" NPT

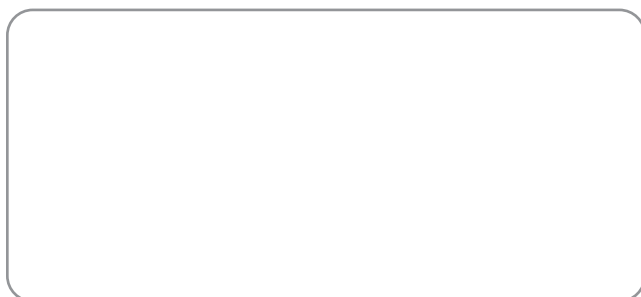

32613 Folsom
Farmington Hills, MI 48336
248-477-2288 | Fx: 248-893-3689
www.hydroniccorp.com